



29 Highfield Court

Rossendale Road, Earl Shilton, LE9 7NS

Offers In The Region Of £87,000



A well appointed, spacious second floor one bedroom flat having the benefit of UPVC double glazing, night storage heating with allocated secure car parking space,



Lounge/Dining room (rear) 17'5" max x 11'2" max (5.32 max x 3.4 max)

Laminate floor, night storage heater and twin uPVC double glazed windows

Bathroom (side) 7'8" x 5'7" (2.33 x 1.69)

Full suite in white, panel bath with electric shower and side glazed screen, wash hand basin wc, ceramic tiling and chrome ladder style electric radiator, extractor and airing cupboard

Kitchen (side) 9'3" max x 11'0" max (2.83 max x 3.35 max)

Stainless steel sink unit, range of base and wall units, finished in soft cream, 4 base and 2 wall, associated work surfaces, split level ceramic hob, electric fan assisted over, ceramic tiled floor, uPVC double glazed window and plumbing for washing machine

Bedroom (front) 11'0" max x 9'6" max (3.36 max x 2.89 max)

UPVC double glazed window, electric panel heater, fitted double wardrobe and base units

Outside

Secure allocated parking

Area Map



Floor Plans

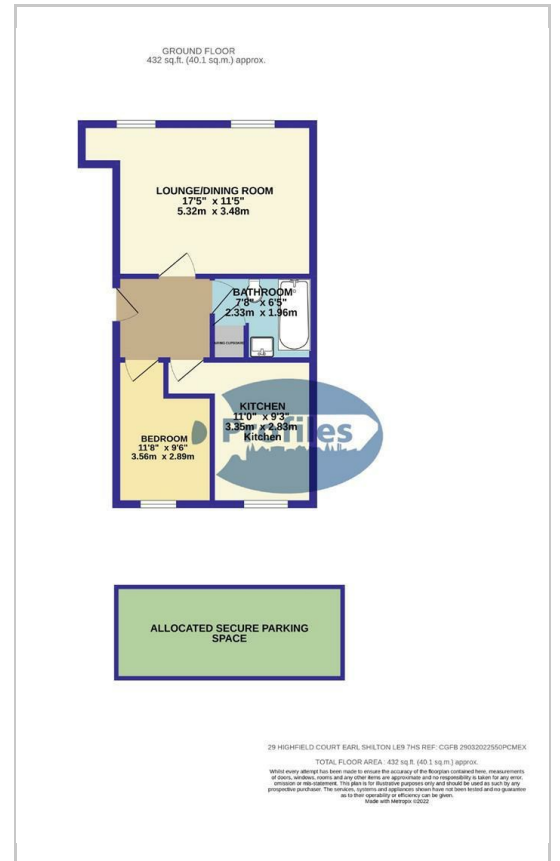

Energy Efficiency Graph

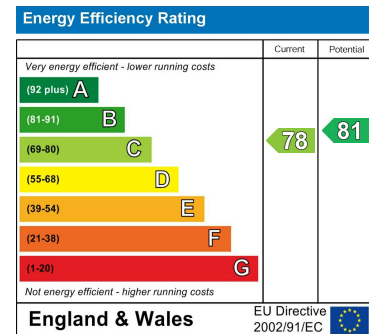

These particulars, whilst believed to be accurate are set out as a general outline only for guidance and do not constitute any part of an offer or contract. Intending purchasers should not rely on them as statements of representation of fact, but must satisfy themselves by inspection or otherwise as to their accuracy. No person in this firms employment has the authority to make or give any representation or warranty in respect of the property.